

Instruction for oral fluid specimen collection

Oral fluid test

Steps

1



Wash hands and put on any personal protective equipment.

2

Ensure donor waits at least ten (10) minutes after ingesting any food, drink, or drugs before collection.

3

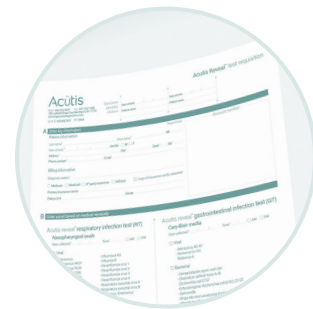

Identify two patient-specific identifiers and complete requisition using patient's name, DOB, specimen collection date and time, and initials of the specimen collector.

4



Before collecting specimen, check the expiration date of the collection device. If expired, do not use and immediately dispose of expired device. Otherwise, open the side of the foil pouch containing the oral fluid collection pad.

5

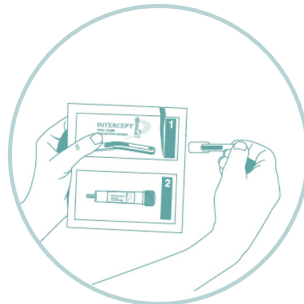

Use the plastic shaft of the device to pull the pad out of the packaging sleeve. Do not touch the pad.

6



Place the pad inside the mouth under the tongue, with the white side of the stick facing upward. Instruct the donor to avoid biting down on the plastic shaft.

7

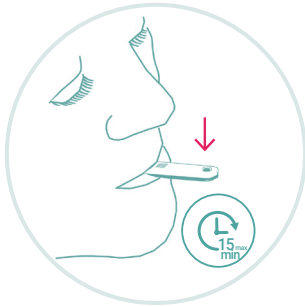

Begin timing the collection process. Keep the pad under the tongue until the indicator turns blue. Average collection times are 3-4 minutes. Should the collection time reach 15 minutes, stop the collection and proceed to step 8.

8

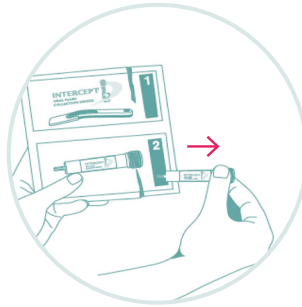

Remove the oral specimen collection vial from the other side of the foil package. Peel one label off the top of the requisition and place on the collection device.

9

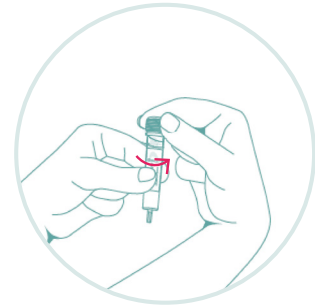

Hold the oral specimen collection vial in an upright position and unscrew the cap to open the vial. Do not spill or otherwise remove the fluid from the vial.

10

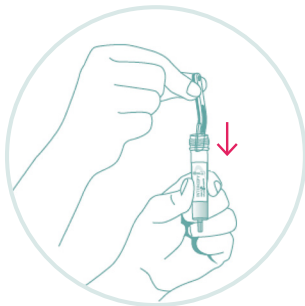

After the collection is complete, remove the oral fluid collection pad from the mouth, insert into the oral specimen collection vial and slowly push downward until reaching the bottom of the vial (pad will be submersed in the preservative solution).

11

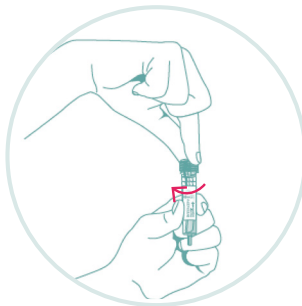

Screw the cap onto the oral specimen collection vial.

12

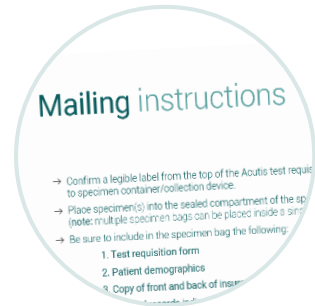

Package the sample and ship to the laboratory.

Instructions for use are adapted from the manufacturer's website www.orasure.com and www.intercept2.com. Intercept i2 oral collection device is manufactured by OraSure Technologies, Inc (Bethlehem, PA). These instructions are made available for your convenience by Acutis Diagnostics. For further questions or concerns, please call us at 516-253-2171.

Mailing instructions

- Confirm patient name, DOB and collection date are legible on the vial
- Place tube into the sealed compartment of the specimen bag
- Be sure to include in the specimen bag the following:
 1. Test requisition form
 2. Patient demographics
 3. Copy of front and back of insurance card
 4. Medical records indicating medical necessity and prescribed medication(s)
- Place the completed specimen bag(s) in the provided protective box
- Place protective box containing specimen bag(s) into the FedEx/UPS Lab Pak and seal the Lab Pak
- Affix prepaid return label on the Lab Pak, and schedule a pickup
- Send to Acutis Diagnostics, 400 Karin Lane, Hicksville, NY 11801